

Bear	Dist	N	S	E	W	D.M.D.	N.A.	S.A.
573E	35.00		10.23	33.47		33.47		343.3981
564E	79.00		34.64	71.00		137.94		5054.1216
578½W	5.66		5.55		1.11	207.83		1153.4565
N64W	115.00	50.42			103.36	103.36	5211.4112	

50.42 50.42 104.47 104.47

6550.9762
 5211.4112
 2) 1339.56
 169.6) 669.78 (3as
 508 8 21
 106) 16098 (151p^s
 106
 549
 530
 198
 106

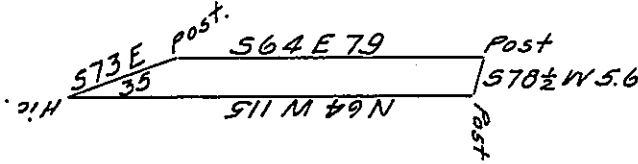

Wm & John Moose in Right
 of Wm Hamiltons Heirs.

A draft of a tract of land containing 3^{as} ^{ps.} 21 p^s & allow. Situate in Madison Township Perry County; Surveyed Oct: 5th 1864 in pursu-
 ance of a Warrant granted W^m & John Moose, March 1st 1864 for
 4½ a^s

Daniel Rife D.S.

To James P. Barr Esqr.
 Surveyor General

IN TESTIMONY that the above is a copy of the original remaining on file in the Department of Internal Affairs of Pennsylvania, made conformably to an Act of Assembly approved the 16th day of February, 1833, I have hereunto set my Hand and caused the Seal of said Department to be affixed at Harrisburg, this twenty-sixth day of April 1906.

Leach R. Brown
 Secretary of Internal Affairs.